

Parts and Instruction
Manual

Yale[®]

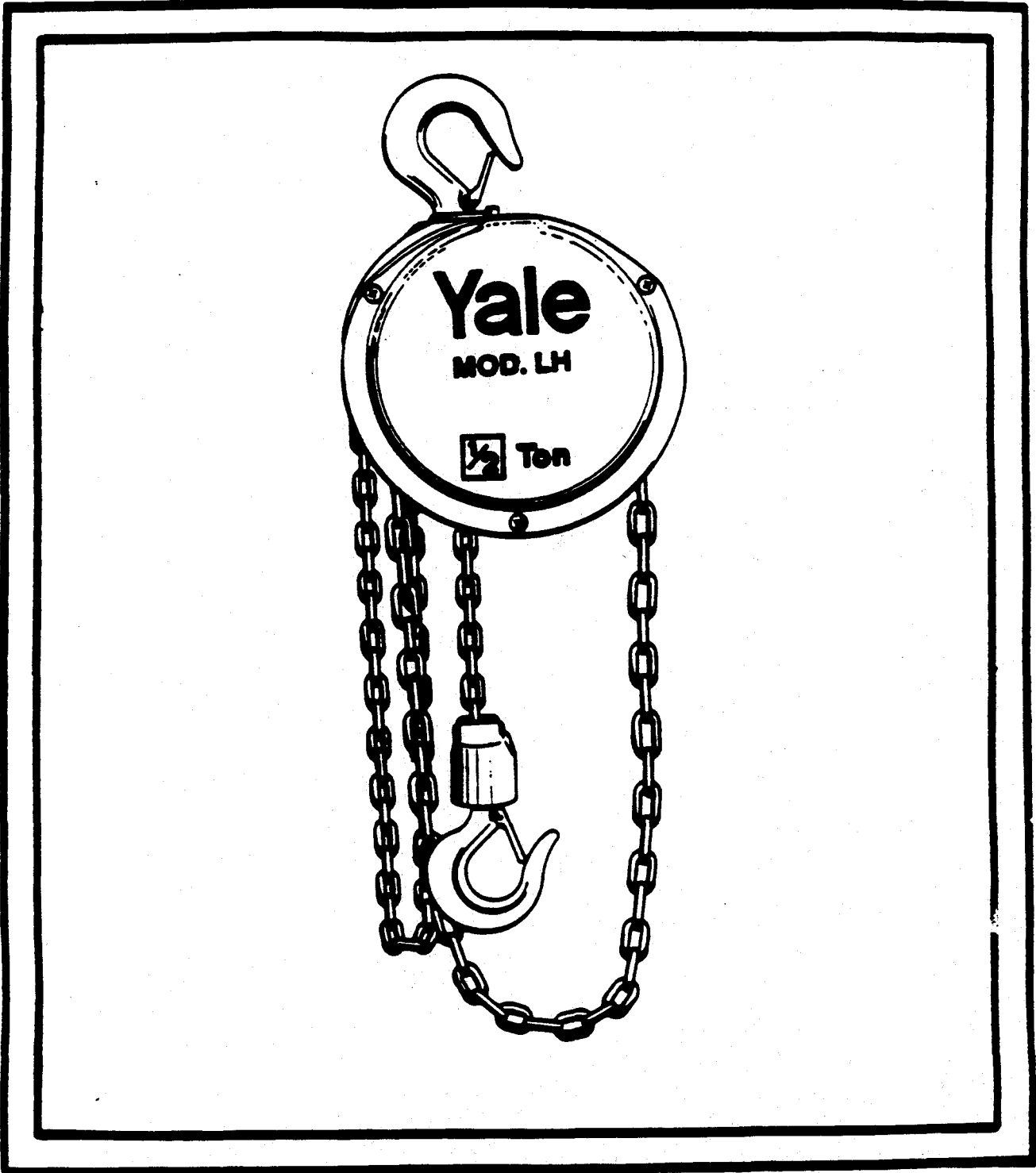

Yale Hoisting Equipment

TABLE OF CONTENTS

	PAGE
INFORMATION FOR ORDERING PARTS	Inside Front Cover
SAFE HOISTING PRACTICES	2
GENERAL INFORMATION	5
Warranty Policy	5
Inspection	5
Chain Reeving	5
PREVENTATIVE MAINTENANCE	6
Daily Inspection	6
Annual Inspection	6
Function Testing Of Hoist	6.1
Repair Parts Ordering Information	6.1
Recommended Spare Parts For One Year	6.1
Chain Attachment.....	6.2
Chain Dimension And Replacement	6.2
Hook Opening Dimension And Replacement	6.3
Hoist Lubrication	6.4
Assembly And Installation	6.4
REPAIR PARTS SECTION	
1/2 Ton LH Series Hand Hoist	7
1 Ton LH Series Hand Hoist	10
1 1/2 Ton LH Series Hand Hoist	13
2 Ton LH Series Hand Hoist	16
3 & 4 Ton LH Series Hand Hoist	19
5 & 6 Ton LH Series Hand Hoist	22
8 Ton LH Series Hand Hoist	25
10 & 12 Ton LH Series Hand Hoist	28
Overload Device	31
INSPECTION RECORDS	Final Pages
WARRANTY	Inside Back Cover

When Replacement Parts Are Needed, Order Only Yale[®] Factory Engineered Parts

NOVEMBER 1980

LH SERIES

SAFE HOISTING PRACTICES

Yale Hand Hoist

For your own safety and that of your fellow workers, Material Handling Equipment must be used and maintained as recommended by the Manufacturer. Failure to heed the following recommendations could endanger your life. Use good common sense and judgement at all times. Safety is the responsibility of the operator of the equipment. You must be competent and attempt to foresee and avoid all hazardous conditions. To be safe as possible, the hoist must be given proper preventative maintenance and testing as described in the **ANSI B30-16 Safety Code for Overhead Hoists** and this Manual.

BEFORE OPERATING HOIST:

1. Do not operate hoist unless you are properly trained, physically fit, and authorized to do so. You must be familiar with all operating controls of the hoist, warnings, and instructions on the hoist, the safe hoisting practices listed in this Manual, **ANSI B30-16 Safety Code for Overhead Hoists**, and all pertinent Federal, State, and local regulations before beginning operation.
2. Do not allow unqualified personnel to operate the hoist.
3. Be familiar with the equipment and its proper care. Do not operate hoist if adjustments or repairs are necessary, if any damage or undue wear is known or suspected, or if any warning, operating, or capacity instructions normally attached to hoist are damaged, obscured or missing. Report same promptly to the proper person and also notify next operator when changing shifts.
4. Conduct periodic visual inspections as described in Preventative Maintenance Section of this Manual and make sure necessary lubrication and repairs are made.
5. Do not operate hoist if it is functioning improperly.
6. Do not operate hoist with an out-of-order sign attached until sign has been removed by a properly authorized person.
7. Do not adjust or repair hoist unless qualified for maintenance of hoist.
8. Do not use chain as ground for welding.
9. Do not touch a welding electrode to the chain.
10. Never attempt to motorize or mechanically operate a hoist designed for manual operation.

When Replacement Parts Are Needed, Order Only Yale® Factory Engineered Parts

SAFE HOISTING PRACTICES (continued)

Yale Hand Hoist

APPLYING THE LOAD:

1. Never wrap the hoist chain around the load, or allow it to drag under load.
2. Use slings or other approved devices to attach load as necessary.
3. Be sure the sling is properly seated in the saddle of the hook. Do not allow hook latch to support any part of load.
4. Do not apply a load to tip of hook, or in such a way as to cause bending or prying forces on the hook or hook support block.
5. Be sure chains are not kinked or twisted or that multiple part chains are not twisted about each other.
6. Do not operate hoist if chain is not seated properly in the sheaves.

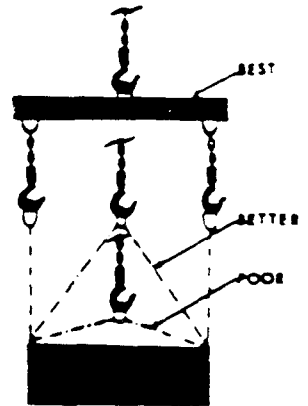

CONSIDER THESE ANGLES WHEN LIFTING LOAD



SEAT LOAD CORRECTLY IN HOOK



DO NOT FORCE HOOK



DO NOT KINK OR TWIST CHAIN

7. Center hoist unit over the load before lifting. Avoid side pull.
8. Never pick up a load beyond the rated capacity appearing on the hoist, except for properly authorized tests. Do not use a load limiting device to measure the maximum load to be lifted, it is a safety device only.



DO NOT OVERLOAD

When Replacement Parts Are Needed, Order Only Yale[®] Factory Engineered Parts

SAFE HOISTING PRACTICES (continued)

Yale Hand Hoist

MOVING THE LOAD:

1. Do not allow more than one operator per hand chain.
2. Do not engage in any activity which will divert your attention while operating hoist.
3. Respond to signals from designated personnel only, except for stop signals.
4. Never lift a load with the hoist until you and all other personnel are clear of load.
5. Make sure a load has proper clearance before moving.
6. Do not lift load more than a few inches until it is well balanced in the sling or lifting device.
7. Each time a loading approaching rated capacity is lifted, check load brake action by raising load just clear of supports and continuing only after you are sure brake is operating properly.
8. Do not transport load over personnel.
9. Never carry personnel on the hook or the load.
10. Avoid swinging of load hook when traveling the hoist.
11. On trolley mounted hoists, avoid sharp contact between trolleys, or between trolleys and rail stops.

PARKING:

1. Do not leave a load suspended in the air for extended or unattended periods.
2. Keep load block above head level when not in use.

SAFETY LAWS FOR PASSENGER ELEVATORS:

The safety laws for passenger elevators specify construction details that are not incorporated in Yale Industrial Hoists. We recommend that passenger elevator operation equipment be used that meets all state and national safety codes. Yale Industrial Products, Inc. will not accept responsibility for applications of Yale Hoists on passenger elevators.

INSPECTION, PREVENTIVE MAINTENANCE AND TESTING

A preventive maintenance program should be initiated for this hoist immediately after it is entered into service. The preventive maintenance program should comply with recommendations in the Service Guide, the applicable Yale Parts and Instruction Manual, and all pertinent Federal, State, and local regulations. Regular inspections, maintenance, and testing required should be followed for the life of the hoist and written inspection records kept as specified. Sample inspection check lists are included at back of this manual. Extra inspection check lists can be obtained from your nearest authorized Yale Distributor.

When Replacement Parts Are Needed, Order Only Yale[®] Factory Engineered Parts

GENERAL INFORMATION

Yale Hand Hoist

Warranty Policy

The warranty policy is located on the back cover and is self-explanatory.

Inspection

Before shipment Hand Hoists are rigidly tested, inspected and carefully adjusted for proper operation. However, it would be wise to inspect for possible damage resulting during shipment and oil the load chain.

Your YALE HAND HOIST is now ready for service. With the proper maintenance and care you should receive many years of service.

Chain Reeving

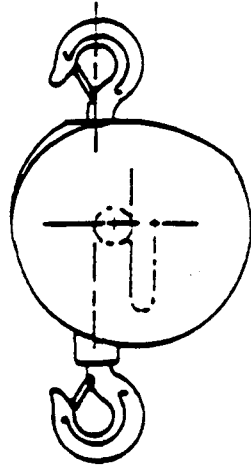

LH 1/2, 1, 1 1/2, 2

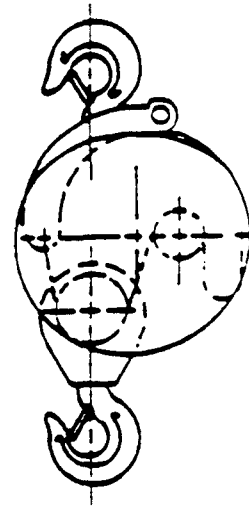

LH 3 - 4

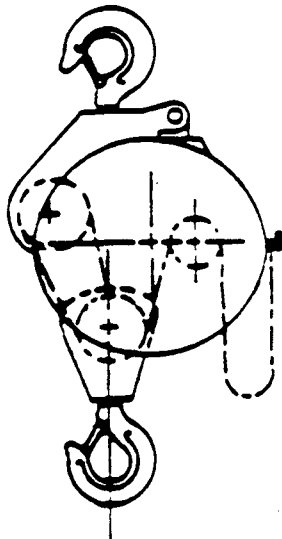

LH 5 - 8

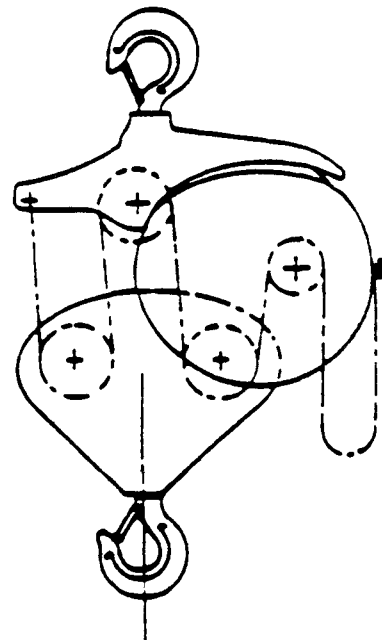

LH 10 - 12

When Replacement Parts Are Needed, Order Only Yale[®] Factory Engineered Parts

PREVENTIVE MAINTENANCE

Inspection is Important

The replacing of parts when worn, at small expense, will make your chain hoist last longer, maintain its efficiency and help prevent accidents due to breakage.

The following recommended inspection periods are based on an average duty, single shift operation of forty (40) hours per week under normal environmental conditions. If the hoist is used in heavier applications or in adverse environmental conditions, the inspections should be made more frequently.

Daily Inspection

Inspect the following items before using the hoist.

- (a) **Braking Mechanism:** Check for slipping brake. Raise a light load a short distance. Stop. If load drifts down load brake should be repaired before further use of hoist.
- (b) **Load Chain:** Check for worn, broken or cracked links. Check for grit, dirt or other foreign matter which may be carried into the hoist mechanism. Check for proper lubrication. Check chain for twists or kinks. If cracks, excessive wear or stretch is observed, see instructions under annual inspection.
- (c) **Hooks:** Check for cracks, chemical damage, or deformation. The bottom hook must swivel freely. If cracks, excessive damage, or excessive deformation is observed, see instructions under annual inspection.

Note: Bent or twisted hooks indicate overloading or abuse of the unit. Other load bearing components of the hoist should be inspected for damage.



CAUTION: Do not operate the hoist if it is functioning improperly or if damage is noted.

Annual Inspection

Inspect the following items at least once every year, or more if need is indicated by daily inspections.

- (a) All items under Daily Inspection.
- (b) **Load Chain and Sheaves:** Check for excessive wear or corrosion of chain, driving load sheaves and bottom block load sheaves. Check for chain stretch. Carefully inspect link chain for wear between the links in section of chain that most often passes over the load sheaves. Check several links, as wear is seldom ever from one link to another.

The chain should be replaced if wear or stretch has increased the specified gauge length beyond the maximum shown in table on page 6.2. If the load chain is worn or stretched and require replacing, also examine the driving load sheaves and load chain guide and stripper. If these parts are worn they should be replaced to avoid damaging the new load chain. The new load chain should be installed with weld on vertical link as shown in Fig. 1, page 6.2. The load chain guide should fit so there is approximately 1/8 inch clearance between the load chain guide side and the outside diameter of the driving load sheave.

- (c) **Hooks:** Dye penetrant, magnetic particle or other suitable crack detecting inspection should be performed if need is indicated by external appearance. Replace hook per Figure 1, page 6.3 if throat opening is in excess of maximum shown in table on page 6.3, or if there is 10 degrees or more twist from normal plane of hook.

When Replacement Parts Are Needed, Order Only Yale® Factory Engineered Parts

PREVENTIVE MAINTENANCE (continued)

Annual Inspection (continued)

- (d) **Hardware:** Check hook retaining nut, collars or pins for wear. Check for loose bolts, nuts or rivets. Check for missing or damaged hook latch.
- (e) **Braking Mechanism:** Check for worn, glazed or oil contaminated friction discs, and worn, broken or cracked pawls or ratchet teeth, corroded, stretched or broken pawl springs.
- (f) **Load Brake:** Turn the handwheel to check the backlash and wear on the load brake parts. Normally, the handwheel should have a back movement equivalent to 1 or 1-1/2 pockets. If this backlash is equivalent to two or more pockets on the handwheel, some of the load brake parts are worn. Inspect the brake disc, oilite disc and spring washer for possible replacement.
- (g) **Load Bearing Parts:** Check for worn, cracked or distorted parts such as hook blocks, suspension housing, chain attachments, clevises, yokes, suspension bolts, gears, shafts, bearings, and trolley wheels.
- (h) **Load Limiting Device:** If hoist is equipped with a load limiting device, check device with 175 percent of rated capacity. If this load can be lifted, device must be repaired or replaced. See applicable parts and instruction manual and function testing instructions below.
- (i) **Warning Labels:** Check for absence or illegibility of warning decals and tags and replace as necessary.
- (j) **Check List:** Fill out an inspection check list at back of this manual, sign date and file for future reference.

Function Testing After Hoist Repair

After repair of hoist, test with a light load for proper function. If load sustaining parts have been altered, load test unit with 125% of the rated capacity by lifting and lowering through a short distance. If a load limiting device has been repaired or replaced, load test unit with 100% of rated capacity and check function of load limiting device with 175% of rated capacity. Also test operation of any other brakes, limit devices, and locking or safety devices, etc. involved in the repair. (If no load sustaining parts were repaired or altered, a normal load lifted may be used for test, and test of the load limiting device may be omitted). A written report of the test should be prepared by the person responsible and kept on file for future reference.



Caution: Prior to testing, all supporting structures, anchorages, and/or suspensions must be approved by the appointed person for the test loads used.

Repair Parts Ordering Information

To insure prompt service, place all parts orders with your local distributor.

- Give complete data from hoist Manual.
- Give part number, description and quantity required.
- Give the correct shipping destination.

Recommended Spare Parts

QTY. PER HOIST	DESCRIPTION	PART NUMBER
1	Brake Disc	0154041-00
1	Oilite Disc	0154042-00
1	Ring Pawl	0156405-00
3	Ring Pawl Spring	0159622-00
1	Spring Washer	0159671-00

Note: All of above can be ordered as Spare Parts Kit 6423062-00

When Replacement Parts Are Needed, Order Only Yale® Factory Engineered Parts

PREVENTIVE MAINTENANCE (continued)

CHAIN ATTACHMENT

Proper positioning of link chain on load sheave.

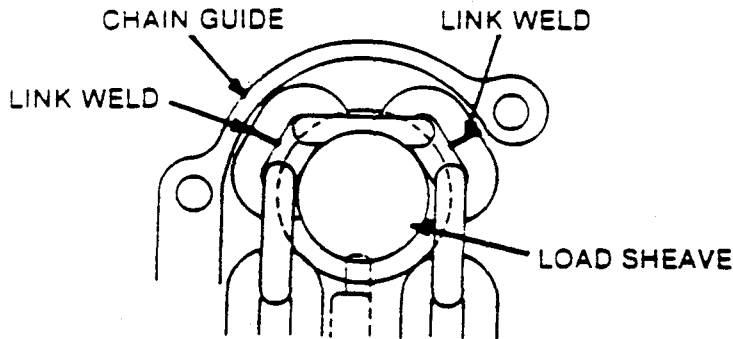

FIGURE 1



Caution: Weld on standing link must face away from driving load sheave.

Load Chain Dimension And Replacement

Note: Gauge lengths should be checked on portion of chain that normally passes over driving load sheave. The gauge length should be checked with a light load on the hook. All dimensions are in inches.

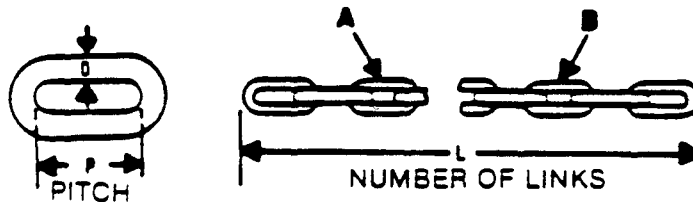

Warning: When replacing link chain use only Yale replacement chain.

Standard Chain Number	Cadmium Plated Chain Number	P Pitch (Inches)	D Dia. (Inches)	Chain Markings At A At B	Links Between Markings A & B	Number Of Links In Gauge Length	Gauge Length "L" Inches (New Chain)	* Gauge Length "L" Inches (Maximum Allowable)
0033640-00	0033641-00	.75	1/4	Y * or Y1 1D	11	19	14.79	15.00
0033645-00	0033646-00	.91	5/16	Y * or Y1 2K	9	19	17.86	18.12
0033650-00	0033651-00	1.13	3/8	Y O 1M	7	19	22.13	22.46
0033655-00	0033656-00	1.31	7/16	Y O 1T	7	15	20.55	20.86



Warning: Replace load chain if "L" exceeds maximum shown.

When Replacement Parts Are Needed, Order Only Yale® Factory Engineered Parts

PREVENTIVE MAINTENANCE (continued)

HOOK INSPECTION

Opening with hook latch

Hook opening dimension in inches

OPENING WITH
SAFETY LATCH



FIGURE 1

LH SERIES HAND HOIST

Capacity In Tons	"E" Top Hook		"E" Bottom Hook	
	Normal	Maximum	Normal	Maximum
1/2	1 5/32	1 27/64	1 1/32	1 7/32
1	1 5/32	1 27/64	1 5/32	1 27/64
1 1/2	1 17/32	1 13/16	1 5/32	1 27/64
2	1 17/32	1 13/16	1 17/32	1 13/16
3	1 17/32	1 13/16	1 5/16	1 37/64
4	1 17/32	1 13/16	1 17/32	1 13/16
5	1 31/32	2 11/32	1 31/32	2 11/32
6	1 31/32	2 11/32	1 31/32	2 11/32
8	2 13/32	2 7/8	2 13/32	2 7/8
10	2 23/32	3 13/64	2 23/32	3 13/64
12	2 23/32	3 13/64	2 23/32	3 13/64



Warning: Replace Hook if "E" dimension exceeds maximum shown in chart.

HOOK REPLACEMENT



Caution: When replacing hook, thoroughly tighten castellated hook nut, and make sure roll pin is properly installed with tight fit in hole.



When Replacement Parts Are Needed, Order Only Yale® Factory Engineered Parts

PREVENTIVE MAINTENANCE (continued)

HOIST LUBRICATION

Lubricant	Lubrication Point	Lubrication Instructions
Houghton Sta Put No.580 Gulf Crown Grease No. 2 Humble Multi Purpose Grease Alvania Grease EP2 Shell Retinex A (or equals)	Load sheave pockets Thread in friction plates Bore and teeth in ratchet disc. Fingers on ring pawl. Ring pawl studs. All gears and pinions. Idler sheave bearings. Trolley wheels.	Apply a light coat of grease at reassembly (or at lube fitting if provided) as needed.
Lubricate before initial operation and at regular interval. Use Yale Part No.5152618-01 Type SS2 (in spray cans) or Yale Part No. 6480531-00 Graphited No. 2 Penetrating Oil for Chain and Cable (in plastic tubes.)	Chain	Apply oil to chain making sure areas between links are completely covered over entire length of chain. Wipe any excess oil off outside surface of chain, leaving oil between links where lubrication is necessary.  Warning: If hoist is operated during chain lubrication, make sure hands and clothing are kept well clear of chain.
Houghton Sta Put 18H2 Atlantic 52 (or equal)	Lower hook bearings	Pack with grease at assembly.

Note: Driving load sheave, driving pinion and intermediate gear and pinion bearings are lubricated for life and sealed. These bearings should not require any maintenance attention. Idler load sheave bearings will require periodic inspection and lubrication based upon frequency of use. All gears are packed with a permanent grease. **Load chain must be kept lubricated for satisfactory service.**

Installation

When installing a new top hook for 3 to 12 Ton capacity units, tighten up the hook nut until nut is in line with hole in top of hook shank. Drive roll pin in place. This will prevent nut from working off.

Assembly And Installation

When the hoist is disassembled for repairs, note the position of all parts to assure proper reassembling.

Check operation of ring pawl and note that it engages ratchet disc properly.

When Replacement Parts Are Needed, Order Only Yale[®] Factory Engineered Parts

REPAIR PARTS

LH Series Hand Hoist

1/2 Ton

ITEM	PART NUMBER	DESCRIPTION	QTY.
1	6494160-00	TOP HOOK ASSY (INCL. ITEMS 1, 3, & 4)	1
1A	6441312-00	TOP HOOK ASSY ZINC PLATED (INCL. ITEMS 1, 3, & 4)	1
2	0151132-00	ADAPTER	1
3	5004068-02	ROLL PIN	1
4	0669402-00	LATCH KIT	1
5	0652673-00	NUT	2
6	6401209-12	SOCKET HEAD SCREW	3
7	0150321-00	LOCKWASHER	7
8	0595197-00	HAND CHAIN GUIDE AND COVER (INCLUDES ITEMS 9 & 10)	1
9	0595021-00	CAPACITY PLATE	1
10	0209149-00	DRIVE SCREW	2
11	0154200-00	COTTER PIN	1
12	0149778-00	SLOTTED NUT	1
13	0161405-00	CHECKWASHER	1
14	0033730-00	HAND CHAIN (SPECIFY LINEAL FEET)	1
14A	0033730-02	HAND CHAIN ZINC, PLATED (SPECIFY LINEAL FEET)	1
15	0165100-00	HANDWHEEL	1
16	0159671-00	SPRING WASHER	1
17	0154042-00	OILITE DISC	1
18	0158079-00	RATCHET DISC	1
19	0154041-00	BRAKE DISC	1
20	0127232-00	FRICTION DISC	1
21	0655757-00	SCREW	1
22	0159148-00	RETAINING RING	3
23	0156405-00	RING PAWL	1
24	0159622-00	RING PAWL SPRING	3
25	0159789-00	RING PAWL STUD, ENDS MUST BE RIVETED OVER AFTER INSTALLATION	3
26	0151277-00	BEARING	3
27	0150322-00	LOCKWASHER (INCLUDED IN ITEM 28)	3
28	A127590-00	HOUSING ASSEMBLY (INCL. ITEMS 25, 27, & 35)	1
29	0655759-00	SOCKET HEAD SCREW	1
30	0325860-00	SHAKEPROOF WASHER	1
31	0164978-00	STRIPPER	1
32	0154178-00	COTTER PIN (INCLUDED IN ITEM 34)	1
33	0161035-00	WASHER (INCLUDED IN ITEM 34)	1

When Replacement Parts Are Needed, Order Only Yale® Factory Engineered Parts

REPAIR PARTS
LH Series Hand Hoist
1/2 Ton

ITEM	PART NUMBER	DESCRIPTION	QTY.
34	0164855-00	LOAD CHAIN GUIDE ASM. (INCL. ITEMS 32 & 33)	1
35	0182571-00	RATCHET LEVER PLUG	2
36	159131-00	RETAINING RING	2
37	0658194-00	SHAKEPROOF WASHER	2
38	065580100	FILLISTER HEAD SCREW	2
39	0155472-00	DRIVING PINION	1
40	0155189-00	GEAR COVER	1
41	6401209-11	SCREW	3
42	5024339-04	RETAINING RING (INCLUDED IN ITEM 46)	1
43	0155355-00	LOAD GEAR	1
44	6400469-06	RETAINING RING	1
45	0151283-00	BEARING	1
46	6420932-00	LOAD SHEAVE & RET. RING KIT (INCL. ITEM 42)	1
47	003364000	LOAD CHAIN (SPECIFY LINEAL FEET)	1
47A	6427004-20	LOAD CHAIN ZINC PLATED (SPECIFY LINEAL FEET)	1
48	6425392-00	BOTTOM BLOCK ASSY (INCL. ITEMS 48 THRU 56)	1
48A	6420171-00	BLOCK HALF	2
49	6428951-00	SOCKET HEAD SCREW	1
50	0150152-00	LOCKNUT	1
51	0106663-00	NUT	1
52	0151221-00	BEARING	1
53	0599891-00	ROLL PIN	1
54	0669400-00	LATCH KIT	1
55	6425402-00	BOTTOM HOOK ASSY, ZINC PLATED (INCL. 51, 53, & 54)	1
56	6456701-00	RETAINER BAND	1
57	6439323-01	WARNING DECAL	1

When Replacement Parts Are Needed, Order Only Yale® Factory Engineered Parts

REPAIR PARTS
LH Series Hand Hoist
1 Ton

ITEM	PART NUMBER	DESCRIPTION	QTY.
1	6494160-00	TOP HOOK ASSY (INCL. ITEMS 1, 3, & 4)	1
1A	6441312-00	TOP HOOK ASSY ZINC PLATED (INCL. ITEMS 1, 3, & 4)	1
2	0151132-00	ADAPTER	1
3	5004099-02	ROLL PIN	1
4	0669402-00	LATCH KIT	1
5	0652673-00	NUT	1
6	6401209-12	SOCKET HEAD SCREW	3
7	0150321-00	LOCKWASHER	7
8	0595198-00	HAND CHAIN GUIDE AND COVER (INCLUDES ITEMS 9 & 10)	1
9	0595028-00	CAPACITY PLATE	1
10	0209149-00	DRIVE SCREW	2
11	0154200-00	COTTER PIN	1
12	0149779-00	SLOTTED NUT	1
13	0161405-00	CHECKWASHER	1
14	0033730-00	HAND CHAIN (SPECIFY LINEAL FEET)	1
14A	0033730-02	HAND CHAIN ZINC, PLATED (SPECIFY LINEAL FEET)	1
15	0165100-00	HANDWHEEL	1
16	0159671-00	SPRING WASHER	1
17	0154042-00	OILITE DISC	1
18	0158079-00	RATCHET DISC	1
19	0154041-00	BRAKE DISC	1
20	0127232-00	FRICTION DISC	1
21	0655757-00	SCREW	1
22	0159148-00	RETAINING RING	3
23	0156405-00	RING PAWL	1
24	0159622-00	RING PAWL SPRING	3
25	0159799-00	RING PAWL STUD, ENDS MUST BE RIVETED OVER AFTER INSTALLATION	3
26	0151277-00	BEARING	3
27	0150322-00	LOCKWASHER (INCLUDED IN ITEM 28)	3
28	A127590-00	HOUSING ASSEMBLY (INCL. ITEMS 25, 27, & 35)	1
29	0655759-00	SOCKET HEAD SCREW	1
30	0325860-00	SHAKEPROOF WASHER	1
31	0164978-00	STRIPPER	1
32	0154178-00	COTTER PIN (INCLUDED IN ITEM 34)	1
33	0161037-00	WASHER (INCLUDED IN ITEM 34)	1

When Replacement Parts Are Needed, Order Only Yale® Factory Engineered Parts

REPAIR PARTS
 LH Series Hand Hoist
 1 Ton

ITEM	PART NUMBER	DESCRIPTION	QTY.
34	0184958-00	LOAD CHAIN GUIDE ASM. (INCL. ITEMS 32 & 33)	1
35	0182571-00	RATCHET LEVER PLUG	2
36	159131-00	RETAINING RING	2
37	0856194-00	SHAKEPROOF WASHER	2
38	085580100	FILLISTER HEAD SCREW	2
39	0155473-00	DRIVING PINION	1
40	0155189-00	GEAR COVER	1
41	6401209-11	SCREW	3
42	5024339-04	RETAINING RING (INCLUDED IN ITEM 46)	1
43	0155356-00	LOAD GEAR	1
44	6400469-06	RETAINING RING	1
45	0151283-00	BEARING	1
46	6420942-00	LOAD SHEAVE & RET. RING KIT (INCL. ITEM 42)	1
47	0033645-00	LOAD CHAIN (SPECIFY LINEAL FEET) (FOR SERVICE ONLY)	1
47A	6427004 26	LOAD CHAIN ZINC PLATED (SPECIFY LINEAL FEET)	1
48	6425962-00	BOTTOM BLOCK ASSY (INCL. ITEMS 48 THRU 56)	1
48A	6420391-00	BLOCK HALF	2
49	6428961-00	SOCKET HEAD SCREW	1
50	0150153-00	LOCKNUT	1
51	0652673-00	NUT	1
52	0151222-00	BEARING	1
53	5004099 02	ROLL PIN	1
54	0669402-00	LATCH KIT	1
55	6425952 00	BOTTOM HOOK ASSY, ZINC PLATED (INCL. 51, 53, & 54)	1
56	6456711-00	RETAINER BAND	1
57	6439323-01	WARNING DECAL	1

When Replacement Parts Are Needed, Order Only Yale® Factory Engineered Parts

REPAIR PARTS
LH Series Hand Hoist
1 1/2 Ton

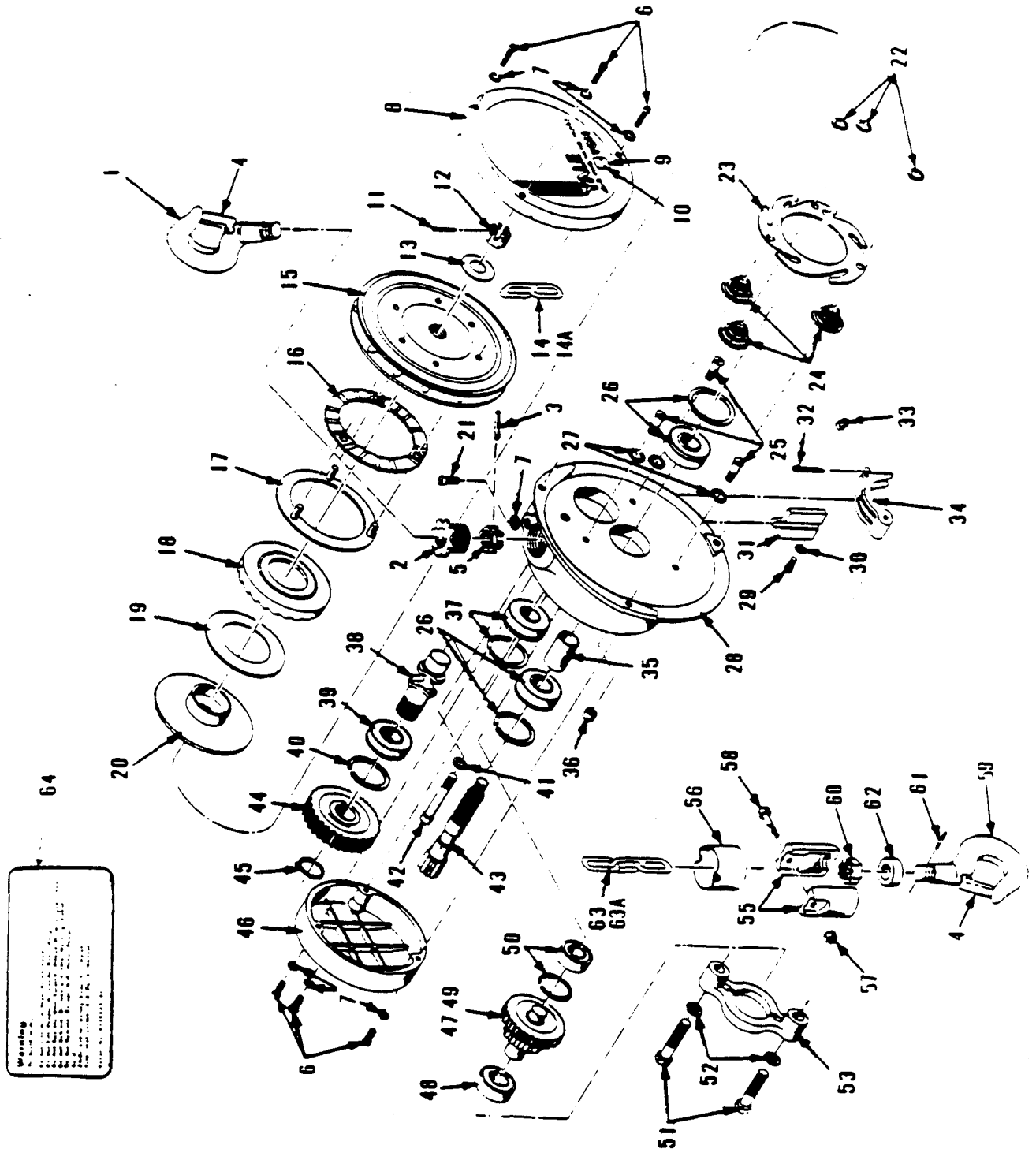

When Replacement Parts Are Needed, Order Only Yale® Factory Engineered Parts

SEPTEMBER 1980

REPAIR PARTS

LH Series Hand Hoist

1 1/2 Ton

ITEM	PART NUMBER	DESCRIPTION	QTY.
1	6430783-00	TOP HOOK ASSY (INCL. ITEMS 1, 3, 4, & 5)	1
1A	6494210-00	TOP HOOK ASSY ZINC PLATED (INCL. ITEMS 1, 3, 4, & 5)	1
2	0151137-00	ADAPTER	1
3	6401449-01	ROLL PIN	2
4	0669404-00	LATCH KIT	2
5	6417721-00	NUT	2
6	6401209-12	SOCKET HEAD SCREW	6
7	0150321-00	LOCKWASHER	7
8	0595199-00	HAND CHAIN GUIDE AND COVER (INCLUDES ITEMS 9 & 10)	1
9		CAPACITY PLATE	1
10		DRIVE SCREW	2
11	0154200-00	COTTER PIN	1
12	0149779-00	SLOTTED NUT	1
13	0161405-00	CHECKWASHER	1
14	0033730-00	HAND CHAIN (SPECIFY LINEAL FEET)	1
14A	0033730-02	HAND CHAIN ZINC, PLATED (SPECIFY LINEAL FEET)	1
15	0165102-00	HANDWHEEL	1
16	0159671-00	SPRING WASHER	1
17	0154042-00	OILITE DISC	1
18	0158079-00	RATCHET DISC	1
19	0154041-00	BRAKE DISC	1
20	0127232-00	FRICTION DISC	1
21	0655757-00	SCREW	1
22	0159148-00	RETAINING RING	3
23	0156405-00	RING PAWL	1
24	0159622-00	RING PAWL SPRING	3
25	0159799-00	RING PAWL STUD, ENDS MUST BE RIVETED OVER AFTER INSTALLATION	3
26	0151277-00	BEARING	3
27	0150322-00	LOCKWASHER	3
28	A127594-00	HOUSING ASSEMBLY (INCL. ITEMS 25, 27 & 36)	1
29	0655843-00	SOCKET HEAD SCREW	1
30	0150365-00	SHAKEPROOF WASHER	1
31	0164980-00	STRIPPER	1
32	0154195-00	COTTER PIN	1
33	0161039-00	WASHER	1

When Replacement Parts Are Needed, Order Only Yale® Factory Engineered Parts

REPAIR PARTS
LH Series Hand Hois
1 1/2 Ton

ITEM	PART NUMBER	DESCRIPTION	QTY.
34	0164962-00	LOAD CHAIN GUIDE (INCL. ITEMS 32, 33 & 34)	1
35	0161948-00	BEARING SPACER	1
36	0182571-00	RATCHET LEVER PLUG	2
37	0151279-00	BEARING	1
38	0165095-00	SHEAVE	1
39	0151281-00	BEARING	1
40	6400469-20	RETAINING RING	1
41	0150368-00	SHAKEPROOF WASHER	1
42	6412041-00	FILLIESTE HEAD SCREW	2
43	0155474-00	DRIVING PINION	2
44	0155365-00	LOAD GEAR	1
45	5024339-03	RETAINING RING	1
46	0155192-00	GEAR COVER	1
47	6427341-00	PINION	1
48	0151283-00	BEARING	1
49	6427351-00	GEAR	1
50	0151278-00	BEARING	1
51	0588309-00	GEAR SUPPORT BOLT	1
52	0150369-00	LOCKWASHER	2
53	0152018-00	GEAR SUPPORT	2
54	6425962-00	BOTTOM BLOCK ASSY (INCL. ITEMS 55 THRU 62)	1
55	6420391-00	BLOCK HALF	1
56	6456711-00	RETAINER BAND	2
57	0150153-00	LOCKNUT	1
58	6428961-00	SOCKET HEAD SCREW	1
59	6425952-00	BOTTOM HOOK ASSY, ZINC PLATED (INCL. NUT, LATCH & ITEM 61)	1
60	0652673-00	NUT	1
61	5004099-02	ROLL PIN	1
62	0151222-00	BEARING	1
63	0033650-00	LOAD CHAIN (SPECIFY LINEAL FEET)	1
63A	6427004-27	LOAD CHAIN ZINC PLATED (SPECIFY LINEAL FEET)	1
64	6439323-01	WARNING DECAL	1

When Replacement Parts Are Needed, Order Only Yale[®] Factory Engineered Parts

REPAIR PARTS
LH Series Hand Hoist
2 Ton

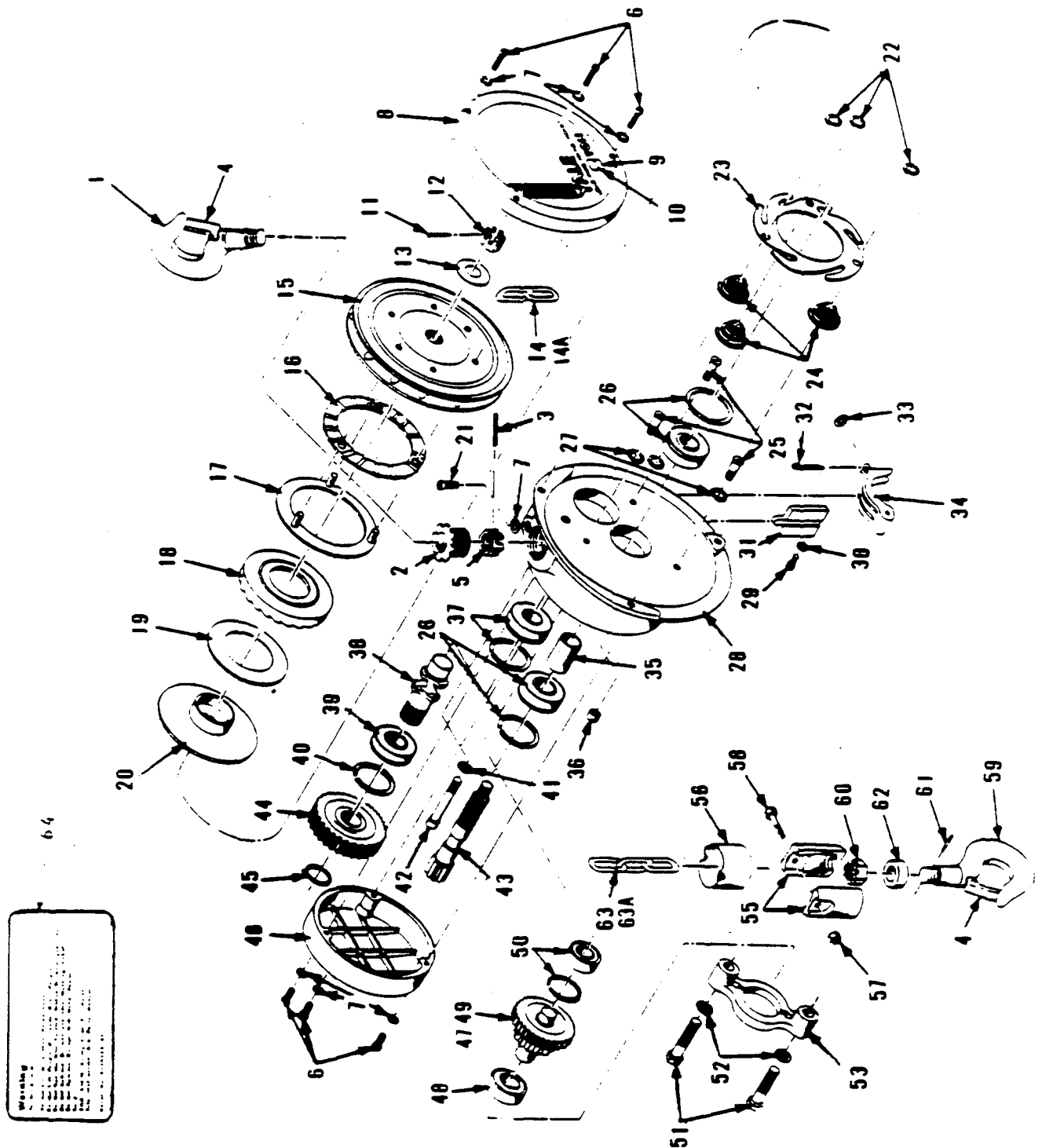

When Replacement Parts Are Needed, Order Only Yale® Factory Engineered Parts
 LH SERIES 16 SEPTEMBER 1980

REPAIR PARTS
LH Series Hand Hoist
2 Ton

ITEM	PART NUMBER	DESCRIPTION	QTY.
1	6430783-00	TOP HOOK ASSY (INCL. ITEMS 1, 3, 4, & 5)	1
1A	6494210-00	TOP HOOK ASSY ZINC PLATED (INCL. ITEMS 1, 3, 4, & 5)	1
2	0151137-00	ADAPTER	1
3	6401449-01	ROLL PIN	2
4	0669404-00	LATCH KIT	2
5	6417721-00	NUT	2
6	6401209-12	SOCKET HEAD SCREW	6
7	0150321-00	LOCKWASHER	7
8	0595200-00	HAND CHAIN GUIDE AND COVER (INCLUDES ITEMS 9 & 10)	1
9		CAPACITY PLATE	1
10		DRIVE SCREW	2
11	0154200-00	COTTER PIN	1
12	0149779-00	SLOTTED NUT	1
13	0161405-00	CHECKWASHER	1
14	0033730-00	HAND CHAIN (SPECIFY LINEAL FEET)	1
14A	0033730-02	HAND CHAIN ZINC, PLATED (SPECIFY LINEAL FEET)	1
15	0165102-00	HANDWHEEL	1
16	0159671-00	SPRING WASHER	1
17	0154042-00	OILITE DISC	1
18	0158079-00	RATCHET DISC	1
19	0154041-00	BRAKE DISC	1
20	0127232-00	FRICTION DISC	1
21	0655757-00	SCREW	1
22	0159148-00	RETAINING RING	3
23	0156405-00	RING PAWL	1
24	0159622-00	RING PAWL SPRING	3
25	0159799-00	RING PAWL STUD, ENDS MUST BE RIVETED OVER AFTER INSTALLATION	3
26	0151277-00	BEARING	3
27	0150322-00	LOCKWASHER	3
28	A127594-00	HOUSING ASSEMBLY (INCL. ITEMS 25, 27, & 36)	1
29	0655843-00	SOCKET HEAD SCREW	1
30	0150365-00	SHAKEPROOF WASHER	1
31	0164980-00	STRIPPER	1
32	0154195-00	COTTER PIN	1
33	T 161096-00	WASHER	1

When Replacement Parts Are Needed, Order Only Yale® Factory Engineered Part

REPAIR PARTS

LH Series Hand Hoist
2 Ton

ITEM	PART NUMBER	DESCRIPTION	QTY.
34	0164965-00	LOAD CHAIN GUIDE (INCL. ITEMS 32, 33 & 34)	1
35	0161946-00	BEARING SPACER	1
36	0182571-00	RATCHET LEVER PLUG	2
37	0151279-00	BEARING	1
38	0165098-00	SHEAVE	1
39	0151281-00	BEARING	1
40	6400469-20	RETAINING RING	1
41	0150368-00	SHAKEPROOF WASHER	2
42	6412041-00	FILLIESTE HEAD SCREW	2
43	0155474-00	DRIVING PINION	1
44	0155368-00	LOAD GEAR	1
45	5024339-03	RETAINING RING	1
46	0155192-00	GEAR COVER	1
47	6427331-00	PINION	1
48	0151283-00	BEARING	1
49	6427321-00	GEAR	1
50	0151278-00	BEARING	1
51	0588309-00	GEAR SUPPORT BOLT	2
52	0150369-00	LOCKWASHER	2
53	0152018-00	GEAR SUPPORT	1
54	6426122-00	BOTTOM BLOCK ASSY (INCL ITEMS 55 THRU 62)	1
55	6420451-00	BLOCK HALF	2
56	6456721-00	RETAINER BAND	1
57	0150155-00	LOCKNUT	1
58	6428971-00	SOCKET HEAD SCREW	1
59	6436252-00	BOTTOM HOOK ASSY, ZINC PLATED (INCL NUT, LATCH & ITEM 61)	1
60	6401379-11	NUT	1
61	0511914-00	ROLL PIN	1
62	0501931-00	BEARING	1
63	0033655-00	LOAD CHAIN (SPECIFY LINEAL FEET)	1
63A	6427004-29	LOAD CHAIN ZINC PLATED (SPECIFY LINEAL FEET)	1
64	6439323-01	WARNING DECAL	1

When Replacement Parts Are Needed, Order Only Yale® Factory Engineered Parts

REPAIR PARTS LH Series Hand Hoist 3 & 4 Ton

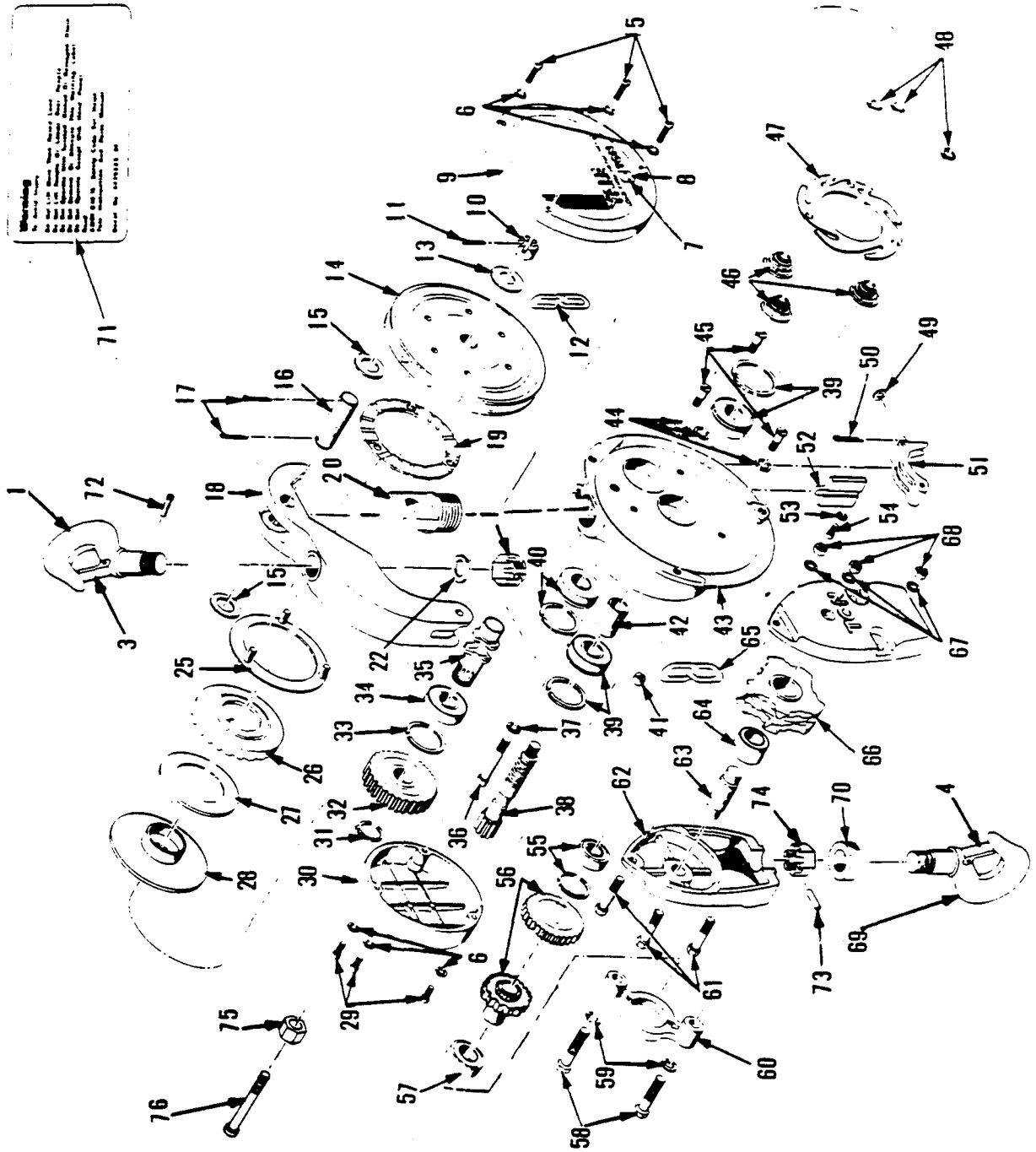

When Replacement Parts Are Needed, Order Only Yale® Factory Engineered Parts

REPAIR PARTS

LH Series Hand Hoist

3 & 4 Ton

ITEM	3 TON PART NO.	4 TON PART NO.	DESCRIPTION	QTY.
1	6494230-00	6494230-00	TOP HOOK ASSY (INCL. ITEMS 2, 3, 4, 22 & 62)	1
2	6418291-00	6418291-00	SLOTTED NUT (INCL. IN ITEM 1)	1
3	0669404-00	0669404-00	HOOK LATCH KIT (INCL. IN ITEM 1)	1
4	0669403-00	0669404-00	HOOK LATCH KIT (INCL. IN ITEM 69)	1
5	6401209-12	6401209-12	SOCKET HEAD SCREW	3
6	0150321-00	0150321-00	LOCKWASHER	6
7	0209149-00	0209149-00	DRIVE SCREW	2
8	0595054-00	0595055-00	CAPACITY PLATE	1
9	0514084-00	0514085-00	HAND CHAIN GUIDE AND COVER ASM. (INCL. ITEM 7 & 8)	1
10	0149779-00	0149779-00	SLOTTED NUT	2
11	0154200-00	0154200-00	COTTER PIN	1
12	0033730-00	0033730-00	HAND CHAIN (SPECIFY LINEAL FEET)	1
13	0161405-00	0161405-00	CHECKWASHER	1
14	0165102-00	0165102-00	HAND WHEEL	1
15	0145788-00	0145788-00	WASHER	1
16	0510484-00	0510484-00	PIN	2
17	0381400-00	0381400-00	COTTER PIN	1
18	6439364-00	6439364-00	YOKE	2
19	0159671-00	0159671-00	SPRING WASHER	1
20	6477671-00	6477671-00	CLEVIS	1
22	0523808-00	0523808-00	WASHER, HARDEN	1
25	0154042-00	0154042-00	OILITE DISC	2
26	0158079-00	0158079-00	RATCHET DISC	1
27	0154041-00	0154041-00	BRAKE DISC	1
28	0127232-00	0127232-00	FRICITION PLATE	1
29	6401209-12	6401209-12	SOCKET HEAD SCREW	1
30	0155192-00	0155192-00	GEAR COVER	3
31	5024339-03	5024339-03	RETAINING RING	1
32	0155365-00	0155366-00	LOAD GEAR	1
33	6400469-20	6400469-20	RETAINING RING	1
34	0151281-00	0151281-00	BEARING	1
35	0165095-00	0165096-00	LOAD SHEAVE	1
36	6412041-00	6412041-00	FILLISTER HEAD SCREW	1
37	0150368-00	0150368-00	SHAKEPROOF WASHER	2
38	0155474-00	0155474-00	DRIVING PINION	2
39	0151277-00	0151277-00	BEARING	1
40	0151279-00	0151279-00	BEARING	2
41	0182571-00	0182571-00	RATCHET LEVER PLUG	1

When Replacement Parts Are Needed, Order Only Yale® Factory Engineered Parts

REPAIR PARTS
LH Series Hand Hoist
3 & 4 Ton

ITEM	3 TON PART NO.	4 TON PART NO.	DESCRIPTION	QTY.
42	0161946-00	0161946-00	BEARING SPACER	1
43	A 127594-00	A 127594-00	HOUSING ASSEMBLY (INCL. ITEMS 41, 44, & 45)	1
44	5021389-01	5021389-01	LOCKWASHER	3
45	0159799-00	0159799-00	RING PAWL STUD, ENDS MUST BE RIVETED OVER AFTER INSTALLATION	3
46	0159622-00	0159622-00	RING PAWL SPRING	3
47	0158405-00	0158405-00	RING PAWL	1
48	0159148-00	0159148-00	RETAINING RING	3
49	0161038-00	T 161096-00	WASHER	1
50	0154196-00	0154196-00	COTTER PIN	1
51	0164962-00	0164965-00	LOAD CHAIN GUIDE (INCL. ITEMS 49, 50, & 51)	1
52	0164980-00	0164980-00	STRIPPER	1
53	0150365-00	0150365-00	LOCKWASHER	1
54	0655843-00	0655843-00	SOCKET HEAD SCREW	1
55	0151278-00	0151278-00	BEARING	1
56	6427351-00	6427321-00	GEAR	1
	6427341-00	6427331-00	PINION	1
57	0151283-00	0151283-00	BEARING	1
58	0588309-00	0588309-00	GEAR SUPPORT BOLT	2
59	0150369-00	0150369-00	LOCKWASHER	2
60	0152018-00	0150218-00	GEAR SUPPORT	1
61	0350234-00	0350234-00	BOLT & NUT	3
62	0510473-00	0510474-00	BOTTOM BLOCK HALF	2
63	0501935-00	0501935-00	SHAFT	1
64	6400269-01	6400269-01	ROLLER BEARING	1
65	0033650-00	0033655-00	LOAD CHAIN (SPECIFY LINEAL FEET)	1
66	0033651-00	0033656-00	LOAD CHAIN CADMIUM PLATED (SPECIFY LINEAL FEET)	1
67	6405463-00	6405453-00	IDLER SHEAVE	1
68	0401003-00	0401003-00	LOCKWASHER	3
69	0149369-00	0149369-00	HEX NUT (INCL. IN ITEM 61)	1
70	6494220-00	6494310-00	BOT. HOOK ASM. (INCL. 2, 3, 4, 70, & 74)	1
71	0501931-00	0501932-00	HOOK BEARING	1
72	6439323-01	6439323-01	WARNING DECAL	1
73	0592947-00	0592947-00	ROLL PIN (INCL. IN ITEM 1)	1
74	0511914-00	0592947-00	ROLL PIN (INCL. IN ITEM 69)	1
75	6418791-00	6418291-00	HOOK NUT (INCL. IN ITEM 69)	1
76	0504959-00	0504959-00	SPECIAL BOLT 7/16 - 14	1
	0588346-00	0588346-00	CROWN NUT 7/16 - 14	1

When Replacement Parts Are Needed, Order Only Yale® Factory Engineered Parts

REPAIR PARTS

LH Series Hand Hoist

5 & 6 Ton

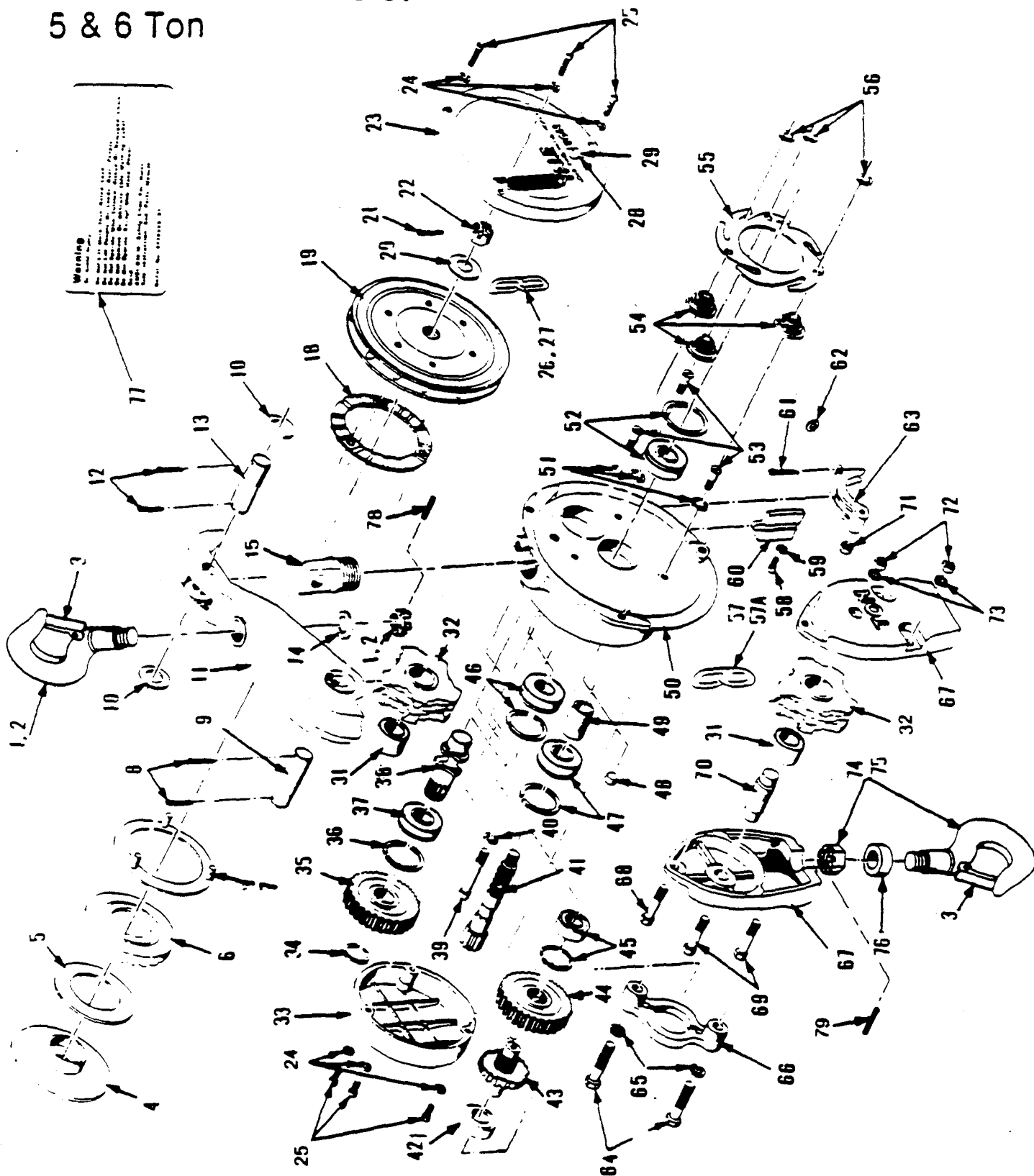

When Replacement Parts Are Needed, Order Only Yale® Factory Engineered Parts

REPAIR PARTS
LH Series Hand Hoist
5 & 6 Ton

ITEM	5 TON PART NO.	6 TON PART NO.	D E S C R I P T I O N	QTY.
1	6494240-00	6494240-00	TOP HOOK ASSY (INCL. ITEMS 3, 14, & 78)	1
2	6441842-00	6441842-00	TOP HOOK ASSY. ZINC PLATED (INCL. ITEMS 3, 14 & 78)	1
3	0669406-00	0669406-00	HOOK LATCH KIT	1
4	0127232-00	0127232-00	FRICTION PLATE	1
5	0154041-00	0154041-00	BRAKE DISC	1
6	0158079-00	0158079-00	RATCHET DISC	1
7	0154042-00	0154042-00	OILITE DISC	1
8	0381401-00	0381401-00	COTTER PIN 1/4 x 1 1/2	2
9	0512251-00	0512251-00	SHAFT	1
10	0145788-00	0145788-00	WASHER 1.535 OD	1
11	6436676-00	6436676-00	SUSPENSION YOKE	2
12	0381400-00	0381400-00	COTTER PIN	1
13	0510484-00	0510484-00	PIN	2
14	0523808-00	0523808-00	WASHER TOP HOOK	1
15	6477671-00	6477671-00	CLEVIS	2
18	0159671-00	0159671-00	SPRING WASHER	1
19	0165102-00	0165102-00	HANDWHEEL	1
20	0161405-00	0161405-00	CHECKWASHER	1
21	0154200-00	0154200-00	COTTER PIN 5/32 x 1 1/4	1
22	0149779-00	0149779-00	SLOTTED NUT 5/8 - 11	1
23	0514086-00	0514087-00	HAND CHAIN GUIDE & COVER (INCL. ITEMS 28 and 29)	1
24	0150321-00	0150321-00	LOCKWASHER 5/16 HI COLLAR	1
25	6401209-12	6401209-12	SOCKET HEAD SCREW 5/16 - 18 x 2 1/4	6
26	0033730-00	0033730-00	HAND CHAIN (SPECIFY LINEAL FEET)	6
27	0033730-02	0033730-02	HAND CHAIN ZINC PLATED (SPECIFY LINEAL FEET)	1
28	0209149-00	0209149-00	DRIVE SCREW	1
29	0595056-00	0595057-00	CAPACITY PLATE	2
31	6400269-01	6400269-01	ROLLER BEARING	1
32	6405463-00	6405463-00	SHEAVE	2
33	0155192-00	0155192-00	GEAR COVER	2
34	5024339-03	5024339-03	RETAINING RING	1
35	0155366-00	0155366-00	LOAD GEAR	1
36	6400469-20	6400469-20	RETAINING RING	1
37	0151281-00	0151281-00	BEARING	1
38	0165095-00	0165095-00	LOAD SHEAVE	1
39	6412041-00	6412041-00	FILLISTER HEAD SCREW 9/16 - 12 x 2 1/2	1
40	0150368-00	0150368-00	SHAKEPROOF WASHER 9/16 INT	2
41	0526155-00	0526155-00	DRIVING PINION	2

When Replacement Parts Are Needed, Order Only Yale® Factory Engineered Parts

REPAIR PARTS

LH Series Hand Hoist

5 & 6 Ton

ITEM	5 TON PART NO.	6 TON PART NO.	DESCRIPTION	QTY.
42	0151283-00	0151283-00	BEARING	1
43	6427331-00	6427331-00	PINION	1
44	6427361-00	6427361-00	GEAR	1
45	0151278-00	0151278-00	BEARING	1
46	0151279-00	0151279-00	BEARING	1
47	0151277-00	0151277-00	BEARING	1
48	0182571-00	0182571-00	PLUG	2
49	0161946-00	0161946-00	BEARING SPACER	1
50	A127594-00	A127594-00	HOUSING ASSEMBLY (INCL ITEMS 48, 51 & 53)	1
51	0150322-00	0150322-00	LOCKWASHER 3/8 HI COLLAR	1
52	0151277-00	0151277-00	BEARING	3
53	0159799-00	0159799-00	RING PAWL STUD, ENDS MUST BE REVETED OVER AFTER INSTALLATION	1
54	0159622-00	0159622-00	RING PAWL SPRING	3
55	0156405-00	0156405-00	RING PAWL	3
56	0159148-00	0159148-00	RETAINING RING	1
57	0033650-00	0033650-00	LOAD CHAIN (SPECIFY LINEAL FEET)	3
57A	0033651-00	0033651-00	LOAD CHAIN CADMIUM PLATED (SPECIFY LINEAL FEET)	1
58	0655843-00	0655843-00	SOCKET HEAD SCREW 7/16 - 14 x 1	1
59	0150365-00	0150365-00	LOCKWASHER 7/16 INT	1
60	0164980-00	0164980-00	STRIPPER	1
61	0154196-00	0154196-00	COTTER PIN 5/32 x 3/4	1
62	0161039-00	0161039-00	WASHER	1
63	0164962-00	0164962-00	LOAD CHAIN GUIDE (INCL. ITEMS 61, 62 & 63)	1
64	0588309-00	0588309-00	GEAR SUPPORT BOLT	1
65	0150369-00	0150369-00	LOCKWASHER 5/8 INT	2
66	0152018-00	0152018-00	GEAR SUPPORT	2
67	0510559-00	0504825-00	BOTTOM BLOCK HALF	1
68	0504959-00	0504959-00	ANCHOR BOLT 7/16 - 14 SPEC	2
69	0185573-00	0185573-00	HEX HEAD BOLT 1/2 - 13 x 2 1/8	1
70	0501935-00	0501935-00	SHAFT	2
71	0588346-00	0588346-00	CROWN LOCKNUT 7/16 - 14	1
72	0149648-00	0149648-00	HEX NUT 1/2 - 13	1
73	0401005-00	0401005-00	LOCKNUT 1/2 MED	2
74	6444002-00	6444002-00	BOTTOM HOOK & BEARING ASSY. STD. (INCL. ITEMS 3, 76, & 78)	2
75	6441852-00	6441852-00	BOTTOM HOOK & BEARING ASSY. ZINC PLATED (INCL. ITEMS 3, 76, & 78)	1
76	0334120-00	0334120-00	HOOK BEARING	1
77	6439323-01	6439323-01	WARNING DECAL	1
78	0592974-00	0592974-00	TOP HOOK NUT ROLL PIN	1
79	0616475-00	0616475-00	BOTTOM HOOK NUT ROLL PIN	1

When Replacement Parts Are Needed, Order Only Yale® Factory Engineered Parts

REPAIR PARTS
LH Series Hand Hoist
8 Ton

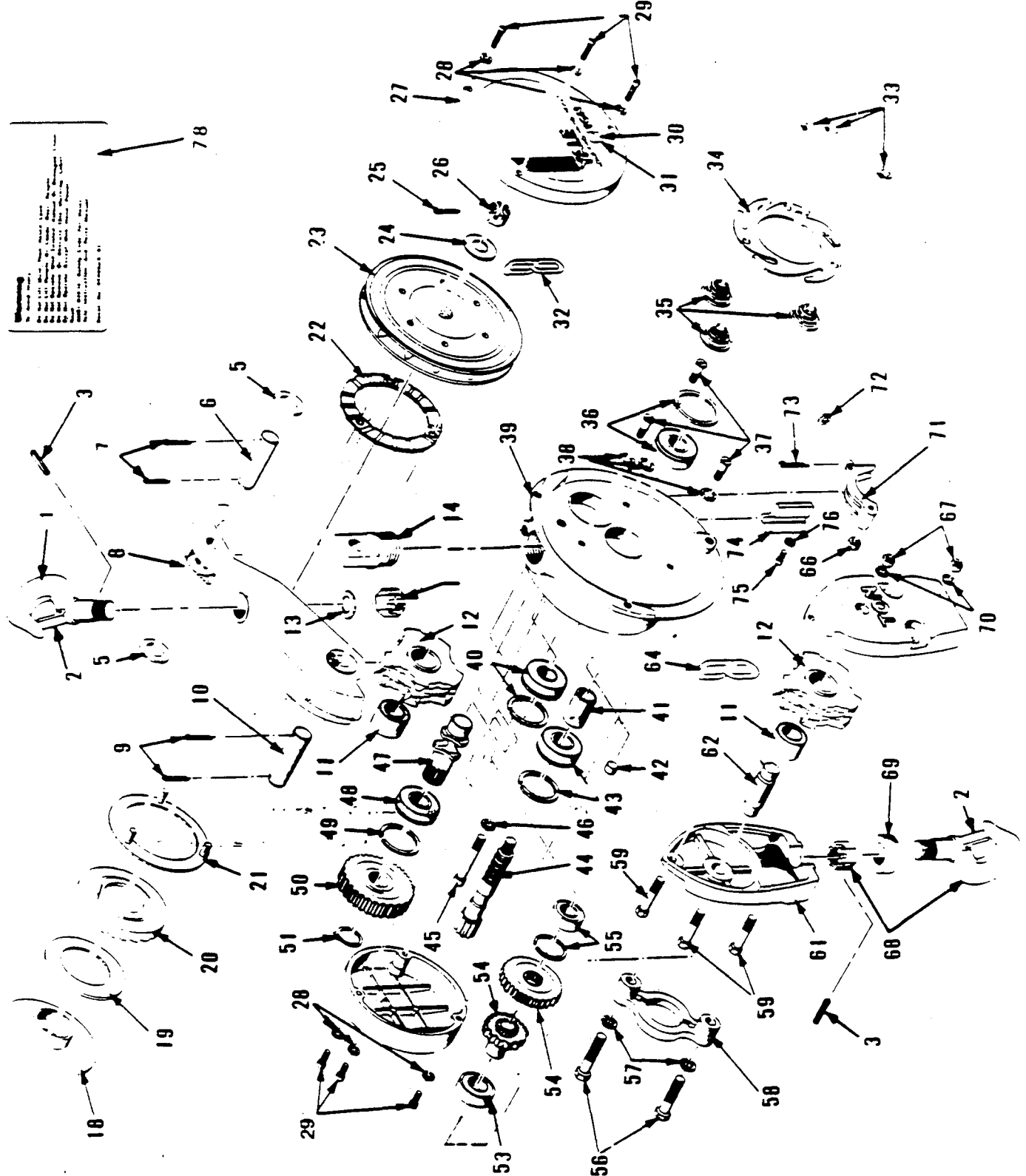

When Replacement Parts Are Needed, Order Only Yale[®] Factory Engineered Parts

REPAIR PARTS

LH Series Hand Hoist

8 Ton

ITEM	8 TON PART NO.	DESCRIPTION	QTY.
1	6494260 00	TOP HOOK ASSY (INCL. ITEMS 2, 3, & 13)	1
2	0669406 00	LATCH KIT (LATCH, SPRING, RIVET)	2
3	0592974 00	ROLL PIN TOP & BOTTOM HOOK NUT	2
5	0145788 00	WASHER	2
6	0510484 00	PIN	1
7	0381400 00	COTTER PIN	2
8	6421028 00	TOP YOKE	1
9	0381401 00	COTTER PIN	2
10	0506510 00	SHAFT	1
11	0513891 00	ROLLER BEARING	2
12	0505401 00	SHEAVE	2
13	0523808 00	WASHER	2
14	6477671 00	TOP CLEVIS	2
18	0127232 00	FRICTION PLATE	1
19	0154041 00	BRAKE DISC	1
20	0158079 00	RATCHET DISC	1
21	0154042 00	OILITE DISC	1
22	0159671 00	SPRING WASHER	1
23	0165102 00	HANDWHEEL	1
24	0161405 00	CHECK WASHER	1
25	0154200 00	COTTER PIN	1
26	0149779 00	SLOTTED NUT	1
27	0514088 00	HAND CHAIN GUIDE AND COVER (INCL. ITEMS 30 & 31)	1
28	0150321 00	LOCKWASHER	1
29	6401209-12	SOCKET HEAD SCREW	6
30	0595058 00	CAPACITY PLATE	3
31	0209149 00	DRIVE SCREW	1
32	0033730 00	HAND CHAIN (SPECIFY LINEAL FEET)	2
33	0159148 00	RETAINING RING	1
34	0156405 00	RING PAWL	3
35	0159622 00	RING PAWL SPRING	1
36	0151277 00	BEARING	3
37	0159799 00	RING PAWL STUD, ENDS MUST BE RIVETED OVER AFTER INSTALLATION	1
38	0150322 00	LOCKWASHER	3
39	A127594 00	HOUSING ASSEMBLY INCL. ITEMS 37, 38, & 42	1
40	0151279 00	BEARING	1

When Replacement Parts Are Needed, Order Only Yale[®] Factory Engineered Parts

REPAIR PARTS
LH Series Hand Hoist
8 Ton

ITEM	8 TON PART NO.	DESCRIPTION	QTY.
41	0161946-00	BEARING SPACER	1
42	0182571-00	PLUG	2
43	0151277-00	BEARING	1
44	0526155-00	DRIVING PINION	1
45	6412041-00	SOCKET HEAD SCREW	2
46	0150368-00	SHAKEPROOF WASHER	2
47	0165096-00	LOAD SHEAVE	1
48	0151281-00	BEARING	1
49	6400469-20	RETAINING RING	1
50	0155366-00	LOAD GEAR	1
51	5024339-03	RETAINING RING	1
53	0151283-00	BEARING	1
54	6427331-00	PINION	1
	6427361-00	GEAR	1
55	0151278-00	BEARING	1
56	0588309-00	GEAR SUPPORT BOLT	2
57	0150369-00	SHAKEPROOF WASHER	2
58	0152018-00	GEAR SUPPORT	1
59	0512370-00	ANCHOR BOLT	3
61	0512226-00	BOTTOM BLOCK HALF	2
62	0506211-00	BOTTOM SHEAVE PIN	1
64	0033655-00	LOAD CHAIN STD. (SPECIFY LINEAL FEET)	1
	0033656-00	LOAD CHAIN PLATED (SPECIFY LINEAL FEET)	1
66	0150155-00	STOVER LOCKNUT	1
67	0149648-00	HEX NUT	2
68	6494270-00	BOTTOM HOOK & BEARING ASSY. (INCL. ITEMS 2, 3, & 69)	1
69	0334120-00	BOTTOM HOOK BEARING	1
70	0401005-00	LOCKWASHER	2
71	0164965-00	LOAD CHAIN GUIDE (INCL. ITEMS 71, 72 & 73)	1
72	T161096-00	PLAIN WASHER	1
73	0154196-00	COTTER PIN	1
74	0164980-00	STRIPPER	1
75	0655843-00	SOCKET HEAD SCREW	1
76	0150365-00	SHAKEPROOF WASHER	1
77	0155192-00	GEAR COVER	1
78	6439323-01	WARNING DECAL	1

When Replacement Parts Are Needed, Order Only Yale[®] Factory Engineered Parts

REPAIR PARTS
LH Series Hand Hoist
10 & 12 Ton



When Replacement Parts Are Needed, Order Only Yale[®] Factory Engineered Parts

REPAIR PARTS
LH Series Hand Hoist
10 & 12 Ton

ITEM	10 TON PART NO.	12 TON PART NO.	DESCRIPTION	QTY.
1	6484280-00	6484280-00	TOP HOOK ASSY (INCL. ITEMS 2, 3, & 9)	1
2	0669407-00	0669407-00	LATCH KIT TOP & BOTTOM HOOK	2
3	0584798-00	0584798-00	ROLL PIN TOP & BOTTOM HOOK	2
5	8420986-00	8420986-00	TOP YOKE	1
6	0145788-00	0145788-00	WASHER 1/8 x 5/8	2
7	0510484-00	0510484-00	PIN	1
8	0381400-00	0381400-00	COTTER PIN	2
9	0511454-00	0511454-00	HARDENED WASHER	2
10	6477671-00	6477671-00	TOP CLEVIS	1
13	0505401-00	0505401-00	TOP SHEAVE	1
14	0513891-00	0513891-00	BEARING	1
15	0512370-00	0512370-00	CHAIN ANCHOR BOLT	1
16	0150155-00	0150155-00	CHAIN ANCHOR BOLT NUT	1
17	0508510-00	0508510-00	SHEAVE SHAFT	1
18	0381401-00	0381401-00	COTTER PIN 1/4 x 1 1/2	2
19	0127232-00	0127232-00	FRICITION PLATE	1
20	0154041-00	0154041-00	BRAKE DISC	1
21	0158079-00	0158079-00	RATCHET DISC	1
22	0154042-00	0154042-00	OILITE DISC	1
23	0159671-00	0159671-00	SPRING WASHER	1
24	0165102-00	0165102-00	HANDWHEEL	1
25	0161405-00	0161405-00	CHECK WASHER	1
26	0154200-00	0154200-00	COTTER PIN 5/32 x 1 1/4	1
27	0149779-00	0149779-00	SLOTTED NUT 5/8 - 11	1
28	0033730-00	0033730-00	HAND CHAIN (SPECIFY LINEAL FEET)	1
29	0514089-00	0514089-00	HAND CHAIN GUIDE AND COVER (INCL. ITEMS 74 & 75)	1
30	0150321-00	0150321-00	LOCKWASHER 5/16 HI COLLAR	1
31	6401209-12	6401209-12	SOCKET HEAD SCREW 5/16 - 18 x 2 1/2	6
32	0159148-00	0159148-00	RETAINING RING	3
33	0156405-00	0156405-00	RING PAWL	1
34	0159622-00	0159622-00	RING PAWL SPRING	3
35	0159789-00	0159789-00	RING PAWL STUD ENDS MUST BE RIVETED OVER AFTER INSTALLATION	3
36	0151277-00	0151277-00	BEARING	2
37	0150322-00	0150322-00	LOCKWASHER 3/8 HI COLLAR	3
39	A127594-00	A127594-00	HOUSING ASSEMBLY (INCL. ITEMS 35, 37, & 46)	1
40	0655843-00	0655843-00	SOCKET HEAD SCREW 7/16 - 14 x 1	1

When Replacement Parts Are Needed, Order Only Yale® Factory Engineered Parts

REPAIR PARTS
 LH Series Hand Hoist
 10 & 12 Ton

ITEM	10 TON PART NO.	12 TON PART NO.	DESCRIPTION	QTY.
41	0150365-00	0150365-00	LOCKWASHER 7/16 INT	1
42	0164980-00	0164980-00	STRIPPER	1
43	0164965-00	0164965-00	LOAD CHAIN GUIDE (INCL. ITEMS 43, 44 & 45)	1
44	T161096-00	T161096-00	WASHER	1
45	0154196-00	0154196-00	COTTER PIN	1
46	0182571-00	0182571-00	PLUG	2
47	0161946-00	0161946-00	BALL BEARING SPACER	1
48	0151279-00	0151279-00	BEARING	1
49	0165096-00	0165096-00	LOAD SHEAVE	1
50	0151281-00	0151281-00	BEARING	1
51	6400469-20	6400469-20	RETAINING RING	1
52	0155366-00	0155366-00	LOAD GEAR	1
53	5024339-03	5024339-03	RETAINING RING	1
54	0155192-00	0155192-00	GEAR COVER	1
55	6401209-12	6401209-12	SOCKET HEAD SCREW 5/16 - 18 x 2 1/2	3
56	6412041-00	6412041-00	SOCKET HEAD CAP SCREW 9/16 - 12 x 2 1/2	2
57	0150368-00	0150368-00	SHAKEPROOF WASHER 9/16 INT	2
58	0526155-00	0526155-00	DRIVING PINION	1
59	0151283-00	0151283-00	BEARING	1
60	6427331-00	6427331-00	PINION	1
	6427361-00	6427361-00	GEAR	1
61	0151278-00	0151278-00	BEARING	1
62	0152018-00	0152018-00	GEAR SUPPORT	1
63	0150369-00	0150369-00	LOCKWASHER 5/8 INT	2
64	0588309-00	0588309-00	GEAR SUPPORT BOLT 5/8 - 11 x 2	2
65	0150155-00	0150155-00	CROWN LOCKNUT 1/2 - 13	4
66	0512299-00	0506296-00	BLOCK HALF	2
67	0513891-00	0513891-00	SHEAVE BEARING	2
68	0505401-00	0505401-00	BOTTOM SHEAVE	2
69	0506511-00	0506511-00	SHEAVE PIN	2
70	0607332-00	0607332-00	HEX BOLT	4
71	6494290-00	6494290-00	BOTTOM BLOCK ASSY. (INCL. ITEMS 2, 3, & 72	1
72	0513892-00	0513892-00	BOTTOM HOOK BEARING	1
73	0033655-00	0033655-00	LOAD CHAIN STD. (SPECIFY LINEAL FEET)	1
	0033656-00	0033656-00	LOAD CHAIN PLATED (SPECIFY LINEAL FEET)	1
74	0595059-00	0595060-00	CAPACITY PLATE	1
75	0209149-00	0209149-00	DRIVE SCREW	2
76	6439323-01	6439323-01	WARNING DECAL	1

When Replacement Parts Are Needed, Order Only Yale® Factory Engineered Parts

REPAIR PARTS LH Series Hand Hoist OVERLOAD DEVICE

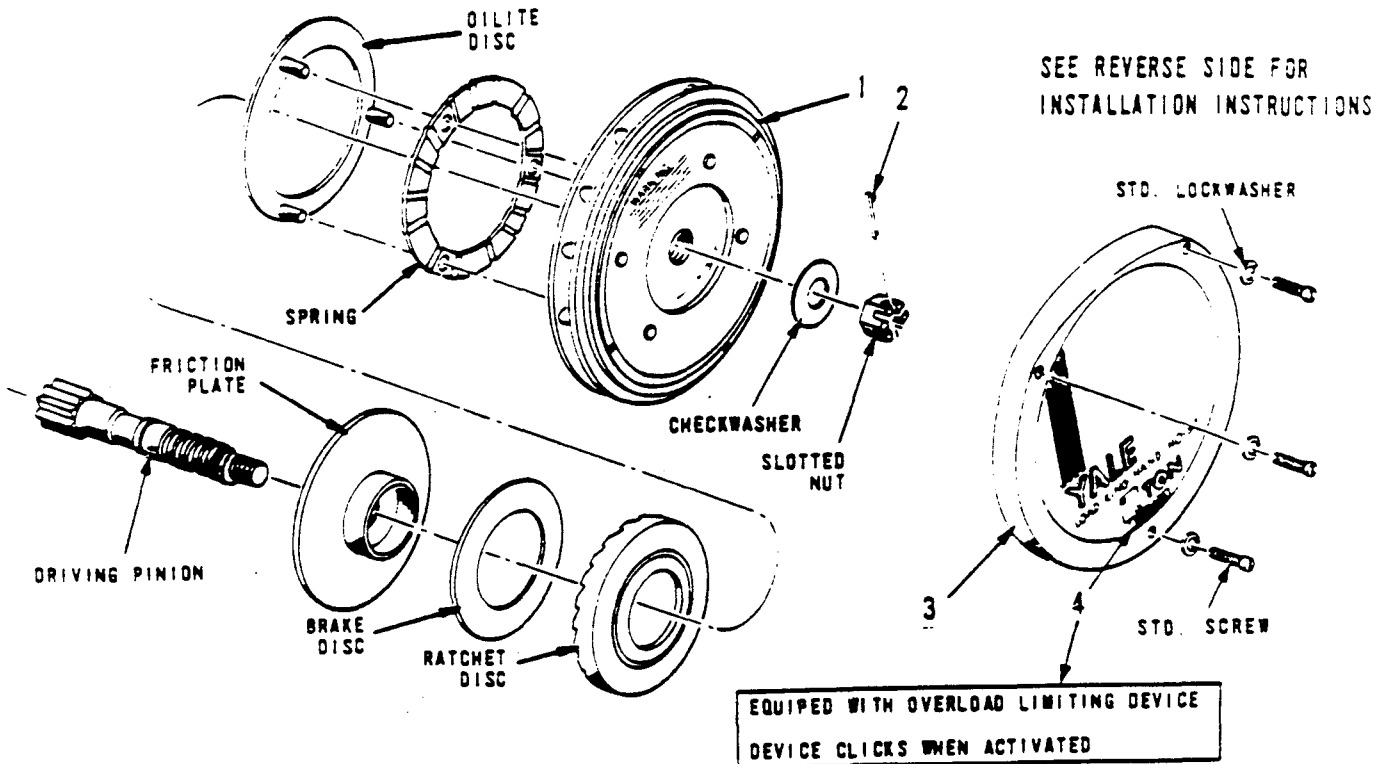

ITEM	PART NUMBER	DESCRIPTION
•	6465180-00	OVERLOAD DEVICE KIT, 1/2 TON
•	6465190-00	OVERLOAD DEVICE KIT, 1 TON
•	6481280-03	OVERLOAD DEVICE KIT, 1 1/2 TON
•	6481280-04	OVERLOAD DEVICE KIT, 2 TON
•	6481280-06	OVERLOAD DEVICE KIT, 3 TON
•	6481280-08	OVERLOAD DEVICE KIT, 4 TON
•	6481280-10	OVERLOAD DEVICE KIT, 5 TON
•	6481280-12	OVERLOAD DEVICE KIT, 6 TON
•	6481280-16	OVERLOAD DEVICE KIT, 8 TON
•	6481280-20	OVERLOAD DEVICE KIT, 10 TON
•	6481280-24	OVERLOAD DEVICE KIT, 12 TON
1	6435744-01	OVERLOAD DEVICE, 1/2 TON
	6435744-02	OVERLOAD DEVICE, 1 TON
	6417826-03	OVERLOAD DEVICE, 1 1/2 TON
	6417826-04	OVERLOAD DEVICE, 2 TON
	6417826-06	OVERLOAD DEVICE, 3 TON
	6417826-08	OVERLOAD DEVICE, 4 TON
	6417826-10	OVERLOAD DEVICE, 5 TON
	6417826-12	OVERLOAD DEVICE, 6 TON
	6417826-16	OVERLOAD DEVICE, 8 TON
	6417826-20	OVERLOAD DEVICE, 10 TON
	6417826-24	OVERLOAD DEVICE, 12 TON
2	0154200-00	COTTER PIN

ITEM	PART NUMBER	DESCRIPTION
3**	6476200-00	COVER, 1/2 TON
3**	6476210-00	COVER, 1 TON
3**	0595199-00	COVER, 1 1/2 TON
3**	0595200-00	COVER, 2 TON
3**	0514084-00	COVER, 3 TON
3**	0514085-00	COVER, 4 TON
3**	0514086-00	COVER, 5 TON
3**	0514087-00	COVER, 6 TON
3**	0514088-00	COVER, 8 TON
3**	0514089-00	COVER, 10 TON
3**	0514090-00	COVER, 12 TON
4	6450728-00	DECAL

*Includes Items 1, 2, 3 & 4 (Select Cap.)

**Includes capacity plate, rivets and decal

When Replacement Parts Are Needed, Order Only Yale® Factory Engineered Parts

REPAIR PARTS

LH Series Hand Hoist

OVERLOAD DEVICE

Installation Instructions

1. Place overload device on a flat surface with the stamped warning down. Place the following parts inside the overload device in this sequence: (1) spring washer, (2) oilite interlock disc (with studs engaged in overload device), (3) ratchet disc (with teeth upward), (4) brake disc and friction plate (with rough side up).

Note Using a large screwdriver jam the load sheave so that the driving pinion will not turn while screwing on the assembly.

2. Grasp the handwheel, holding the parts to prevent them from slipping, and invert the assembly so that the stamped warning is up.

3. Screw the assembly on the driving pinion by rotating clockwise.

4. Place the check washer on the driving pinion and screw the slotted nut up snug, back off to the nearest cotter pin hole and insert cotter pin.

5. Add hand chain.

6. Place the cover on unit and secure with screws and lockwashers.

7. Place decal on cover.

CAUTION: When load tested, if the hoist lifts a load of more than 175 percent of rated capacity or slips at less than 125 percent of rated capacity, the overload device should be replaced.

When Replacement Parts Are Needed, Order Only Yale® Factory Engineered Parts

POWERED HOIST INSPECTION CHECK LIST

SEE PREVENTIVE MAINTENANCE SECTION OF INSTRUCTION MANUAL FOR DETAILS.

CHECK ONLY COMPONENTS APPLICABLE FOR SPECIFIC EQUIPMENT AND INSPECTION TYPE.

HOIST MODEL _____

HOIST S/N _____

HOOKS	YES	NO	CABLE	YES	NO	CHAINS	YES	NO
HARDWARE LOOSE	<input type="checkbox"/>	<input type="checkbox"/>	BROKEN WIRES AT ENDS	<input type="checkbox"/>	<input type="checkbox"/>	BINDING	<input type="checkbox"/>	<input type="checkbox"/>
CRACKS	<input type="checkbox"/>	<input type="checkbox"/>	BROKEN WIRES EXCESSIVE	<input type="checkbox"/>	<input type="checkbox"/>	CRACKED	<input type="checkbox"/>	<input type="checkbox"/>
EXCESSIVE WEAR	<input type="checkbox"/>	<input type="checkbox"/>	EXCESSIVE WEAR	<input type="checkbox"/>	<input type="checkbox"/>	TWISTED	<input type="checkbox"/>	<input type="checkbox"/>
BENT	<input type="checkbox"/>	<input type="checkbox"/>	KINKED OR DISTORTED	<input type="checkbox"/>	<input type="checkbox"/>	DISTORTED	<input type="checkbox"/>	<input type="checkbox"/>
SPREADING	<input type="checkbox"/>	<input type="checkbox"/>	CORROSION	<input type="checkbox"/>	<input type="checkbox"/>	CORRODED	<input type="checkbox"/>	<input type="checkbox"/>
FREELY ROTATE	<input type="checkbox"/>	<input type="checkbox"/>	HEAT DAMAGED	<input type="checkbox"/>	<input type="checkbox"/>	EXCESSIVE WEAR	<input type="checkbox"/>	<input type="checkbox"/>
LATCH DAMAGED	<input type="checkbox"/>	<input type="checkbox"/>				WORN CHAIN GUIDES	<input type="checkbox"/>	<input type="checkbox"/>
						POCKET WHEELS WORN	<input type="checkbox"/>	<input type="checkbox"/>
BRAKES	YES	NO	WIRING	YES	NO	DRUM & SHEAVES	YES	NO
MOTOR BRAKE WORN OR NOT OPERATING	<input type="checkbox"/>	<input type="checkbox"/>	LOOSE CONNECTIONS	<input type="checkbox"/>	<input type="checkbox"/>	WORN EXCESSIVELY	<input type="checkbox"/>	<input type="checkbox"/>
EXCESSIVE LOADBRAKE DRIFT OR BLACKLASH	<input type="checkbox"/>	<input type="checkbox"/>	FRAYED	<input type="checkbox"/>	<input type="checkbox"/>	CRACKED OR SCORED	<input type="checkbox"/>	<input type="checkbox"/>
EXCESSIVE DISC WEAR	<input type="checkbox"/>	<input type="checkbox"/>	DAMAGED	<input type="checkbox"/>	<input type="checkbox"/>			
			PROPER GROUNDING	<input type="checkbox"/>	<input type="checkbox"/>			
LIMIT SWITCHES	YES	NO	LOAD LIMITING DEVICE	YES	NO	COLLECTORS	YES	NO
OPERATING PROPERLY	<input type="checkbox"/>	<input type="checkbox"/>	OPERATING PROPERLY	<input type="checkbox"/>	<input type="checkbox"/>	BINDING	<input type="checkbox"/>	<input type="checkbox"/>
						EXCESSIVE WEAR	<input type="checkbox"/>	<input type="checkbox"/>
HOUSING	YES	NO	OPERATION CONTROLS	YES	NO	LUBRICATION	YES	NO
DISTORTED	<input type="checkbox"/>	<input type="checkbox"/>	CONTACTOR PITTING	<input type="checkbox"/>	<input type="checkbox"/>	ALL POINTS LUBRICATED AS GIVEN IN LUB CHART	<input type="checkbox"/>	<input type="checkbox"/>
CRACKS	<input type="checkbox"/>	<input type="checkbox"/>	OPERATING PROPERLY	<input type="checkbox"/>	<input type="checkbox"/>	OIL DARK OR LOW	<input type="checkbox"/>	<input type="checkbox"/>
LOOSE HARDWARE	<input type="checkbox"/>	<input type="checkbox"/>	DAMAGED PUSH BUTTON HOUSING	<input type="checkbox"/>	<input type="checkbox"/>	OIL LEAKS	<input type="checkbox"/>	<input type="checkbox"/>
BEARING NOISE	<input type="checkbox"/>	<input type="checkbox"/>						
SUPPORTING STRUCTURE	YES	NO	AIR SYSTEM	YES	NO	WARNING LABELS	YES	NO
CONTINUED ABILITY TO SUPPORT IMPOSED LOADS	<input type="checkbox"/>	<input type="checkbox"/>	LEAKING	<input type="checkbox"/>	<input type="checkbox"/>	MISSING	<input type="checkbox"/>	<input type="checkbox"/>
WORN OR DISTORTED TROLLEY PARTS	<input type="checkbox"/>	<input type="checkbox"/>	LOOSE CONNECTIONS	<input type="checkbox"/>	<input type="checkbox"/>	ILLEGIBLE	<input type="checkbox"/>	<input type="checkbox"/>
			BROKEN CONTROL PENDANT	<input type="checkbox"/>	<input type="checkbox"/>			

NOTE: IF ANY () IS CHECKED DO NOT OPERATE THE HOIST UNTIL REPAIRS HAVE BEEN MADE.

REMARKS AND REPAIRS MADE _____

SIGNATURE _____ DATE _____ CLOCK NUMBER _____

POWERED HOIST INSPECTION CHECK LIST

SEE PREVENTIVE MAINTENANCE SECTION OF INSTRUCTION MANUAL FOR DETAILS.

CHECK ONLY COMPONENTS APPLICABLE FOR SPECIFIC EQUIPMENT AND INSPECTION TYPE.

HOIST MODEL _____

HOIST S/N _____

HOOKS	YES	NO	CABLE	YES	NO	CHAINS	YES	NO
HARDWARE LOOSE	<input type="checkbox"/>	<input type="checkbox"/>	BROKEN WIRES AT ENDS	<input type="checkbox"/>	<input type="checkbox"/>	BINDING	<input type="checkbox"/>	<input type="checkbox"/>
CRACKS	<input type="checkbox"/>	<input type="checkbox"/>	BROKEN WIRES EXCESSIVE	<input type="checkbox"/>	<input type="checkbox"/>	CRACKED	<input type="checkbox"/>	<input type="checkbox"/>
EXCESSIVE WEAR	<input type="checkbox"/>	<input type="checkbox"/>	EXCESSIVE WEAR	<input type="checkbox"/>	<input type="checkbox"/>	TWISTED	<input type="checkbox"/>	<input type="checkbox"/>
BENT	<input type="checkbox"/>	<input type="checkbox"/>	KINKED OR DISTORTED	<input type="checkbox"/>	<input type="checkbox"/>	DISTORTED	<input type="checkbox"/>	<input type="checkbox"/>
SPREADING	<input type="checkbox"/>	<input type="checkbox"/>	CORROSION	<input type="checkbox"/>	<input type="checkbox"/>	CORRODED	<input type="checkbox"/>	<input type="checkbox"/>
FREELY ROTATE	<input type="checkbox"/>	<input type="checkbox"/>	HEAT DAMAGED	<input type="checkbox"/>	<input type="checkbox"/>	EXCESSIVE WEAR	<input type="checkbox"/>	<input type="checkbox"/>
LATCH DAMAGED	<input type="checkbox"/>	<input type="checkbox"/>				WORN CHAIN GUIDES	<input type="checkbox"/>	<input type="checkbox"/>
						POCKET WHEELS WORN	<input type="checkbox"/>	<input type="checkbox"/>
<hr/>								
BRAKES	YES	NO	WIRING	YES	NO	DRUM & SHEAVES	YES	NO
MOTOR BRAKE WORN OR NOT OPERATING	<input type="checkbox"/>	<input type="checkbox"/>	LOOSE CONNECTIONS	<input type="checkbox"/>	<input type="checkbox"/>	WORN EXCESSIVELY	<input type="checkbox"/>	<input type="checkbox"/>
EXCESSIVE LOADBRAKE DRIFT OR BLACKLASH	<input type="checkbox"/>	<input type="checkbox"/>	FRAYED	<input type="checkbox"/>	<input type="checkbox"/>	CRACKED OR SCORED	<input type="checkbox"/>	<input type="checkbox"/>
EXCESSIVE DISC WEAR	<input type="checkbox"/>	<input type="checkbox"/>	DAMAGED	<input type="checkbox"/>	<input type="checkbox"/>			
			PROPER GROUNDING	<input type="checkbox"/>	<input type="checkbox"/>			
<hr/>								
LIMIT SWITCHES	YES	NO	LOAD LIMITING DEVICE	YES	NO	COLLECTORS	YES	NO
OPERATING PROPERLY	<input type="checkbox"/>	<input type="checkbox"/>	OPERATING PROPERLY	<input type="checkbox"/>	<input type="checkbox"/>	BINDING	<input type="checkbox"/>	<input type="checkbox"/>
						EXCESSIVE WEAR	<input type="checkbox"/>	<input type="checkbox"/>
<hr/>								
HOUSING	YES	NO	OPERATION CONTROLS	YES	NO	LUBRICATION	YES	NO
DISTORTED	<input type="checkbox"/>	<input type="checkbox"/>	CONTACTOR PITTING	<input type="checkbox"/>	<input type="checkbox"/>	ALL POINTS LUBRICATED AS GIVEN IN LUB CHART	<input type="checkbox"/>	<input type="checkbox"/>
CRACKS	<input type="checkbox"/>	<input type="checkbox"/>	OPERATING PROPERLY	<input type="checkbox"/>	<input type="checkbox"/>	OIL DARK OR LOW	<input type="checkbox"/>	<input type="checkbox"/>
LOOSE HARDWARE	<input type="checkbox"/>	<input type="checkbox"/>	DAMAGED PUSH BUTTON	<input type="checkbox"/>	<input type="checkbox"/>	OIL LEAKS	<input type="checkbox"/>	<input type="checkbox"/>
BEARING NOISE	<input type="checkbox"/>	<input type="checkbox"/>	HOUSING	<input type="checkbox"/>	<input type="checkbox"/>			
<hr/>								
SUPPORTING STRUCTURE	YES	NO	AIR SYSTEM	YES	NO	WARNING LABELS	YES	NO
CONTINUED ABILITY TO SUPPORT IMPOSED LOADS	<input type="checkbox"/>	<input type="checkbox"/>	LEAKING	<input type="checkbox"/>	<input type="checkbox"/>	MISSING	<input type="checkbox"/>	<input type="checkbox"/>
WORN OR DISTORTED TROLLEY PARTS	<input type="checkbox"/>	<input type="checkbox"/>	LOOSE CONNECTIONS	<input type="checkbox"/>	<input type="checkbox"/>	ILLEGIBLE	<input type="checkbox"/>	<input type="checkbox"/>
			BROKEN CONTROL PENDANT	<input type="checkbox"/>	<input type="checkbox"/>			

NOTE: IF ANY () IS CHECKED DO NOT OPERATE THE HOIST UNTIL REPAIRS HAVE BEEN MADE.

REMARKS AND REPAIRS MADE _____

SIGNATURE _____ DATE _____ CLOCK NUMBER _____

Yale[®]

HOISTS

WARRANTY

Every hoist is thoroughly inspected and tested prior to shipment from the factory. Should any problems develop, return the complete hoist prepaid to your nearest Yale Hoists Authorized Warranty Repair Station.

This warranty does not apply where: (1) deterioration is caused by normal wear, abuse, improper or inadequate power supply, eccentric or side loading, overloading, chemical or abrasive actions, improper maintenance or excessive heat; (2) problems resulted from repairs, modifications or

alterations made by persons other than factory or Yale Hoists personnel; (3) the hoist has been abused or damaged as a result of an accident; (4) repair parts or accessories other than those supplied by Yale Hoists are used on the hoist. Equipment and accessories not of the seller's manufacture are warranted only to the extent that they are warranted by the manufacturer. EXCEPT AS STATED HEREIN, YALE HOISTS MAKES NO OTHER WARRANTIES, EXPRESS OR IMPLIED, INCLUDING WARRANTIES OF MERCHANTABILITY AND FITNESS FOR A PARTICULAR PURPOSE.

Improvements:

Yale Hoists is constantly striving to improve its product. Changes in design and improvements will be made whenever manufacturer believes the efficiency of the product will be improved without incurring any obligation to incorporate such improvements in any products which have been shipped or are in service.

Important Notice:

Use of chain, wire rope or replacement parts other than as supplied as original equipment on Yale hoists may lead to dangerous operation. Accordingly, Yale Hoists cannot be responsible in such cases and our warranty will be voided.

For more information, write Yale Hoists, Forrest City, Arkansas 72335.

Yale[®] HOISTS
3105 N. Washington
P. O. Box 1000
Forrest City, Arkansas 72335
Customer Service (800) 999-6318
FAX (800) 766-0223